

Notes:
 - Do not scale from this drawing. Use figured dimensions in all cases.
 - Verify dimensions on site and report any discrepancies to the Architect immediately.
 - This drawing is to be read in conjunction with the Architect's Specification.
 - © This drawing is copyright and may only be reproduced with the Architect's permission.

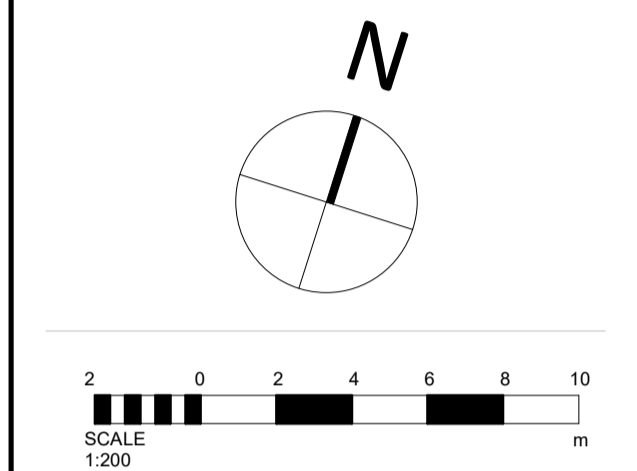
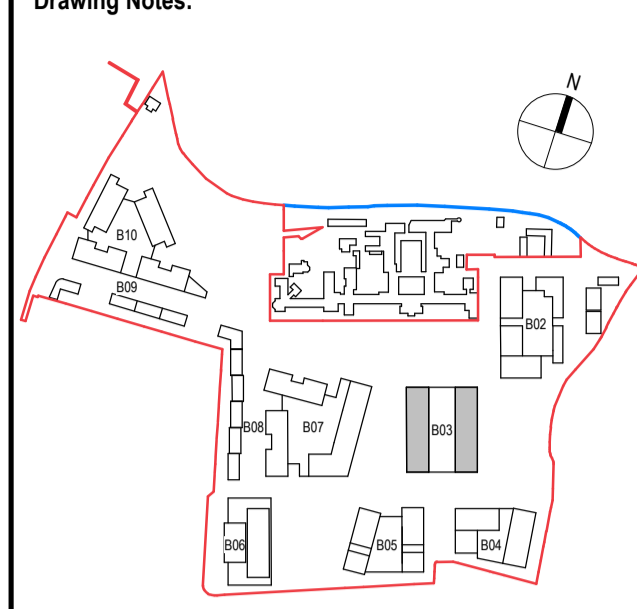

- Planning Legend**
- Site Boundary —
 - Residential Entrance ▲
 - Service Entrance ▲
 - 1B2P
 - 2B3P
 - 2B4P
 - 3B5P
 - Amenity
 - Restaurant
 - Retail

Rev.	Date	Drawn	Details of Issue / Revision
P3-S-1	Sept 2024	KP	Part 10 Planning Application

reddy architecture + urbanism

Dartry Mills,
 Dartry Road
 Dublin 6,
 D06 Y0E3

T: +353 (0)1 498 7000
 W: www.reddyarchitecture.com
 E: info@reddyarchitecture.com

Applicant Details:
 Dún Laoghaire-Rathdown County Council

Agent Details:
 Land Development Agency

Project Details:
 Proposed Part 10 Residential Development,
 Dundrum Central Development,
 Dundrum Road,
 Dublin 14

Drawing Title:
 Block 03, Roof Plan, GA Plan

Job No. P19-233D	Sheet Size: A1_Landscape	Scale @A1: 1:200
Issue Date: Sept 2024	Drawn By: K. Potocka	Reviewed By: R. Quinn
Status: P3	Purpose of Issue: Part 10 Planning Application	
Project - System - Spatial Zone - Level - Type - Originator - Role - Number DCD-02-B03-RF-DR-RAU-AR-1308		Revision P3-S-1